



SWIMMING POOL REQUIREMENTS AND REGULATIONS

Permits Required: Zoning, building, electrical, curb escrow.

General Requirements:

- Any body of water 24" or more deep, intended for swimming, is defined as a swimming pool. This includes in-ground, aboveground, and on-ground pools spas and hot tubs.
- All swimming pools are required to have a barrier (fence minimum 48" tall) around the pool area. Gates in the barrier must open outward (away from the pool) and be self closing/self latching. Latch heights are also regulated.
- When the house has direct access to the pool area, specific door alarms are required on any door accessing the enclosed pool area.
- Inflatable, on-ground pools are not exempt from the barrier requirements.
- Walls of an above ground pool 48" minimum above grade can be considered a barrier; any ladders or steps must be removable or latch and secure in the up position.
- Solid hot tub covers must comply with ASTM 1346 which requires they support a given weight, are lockable, and must be permanently marked with a label on the cover. If the cover meets these requirements no additional enclosure/protection is needed.
- Plastic children's pools, intended to be immediately emptied after each use, are exempt for the barrier requirements.
- To avoid creating a climbable bypass of a barrier, no materials or equipment are to be stored against the exterior of any enclosure.

Plan Requirements:

- 2 sets of drawings indicating the pool's distance from property lines and existing structures (house, decks, patio, etc.), and the location of fencing (include height, style and gate information). Provide typical sectional drawings for in-ground pools, indicating depths and distances from walls and diving board if any.
- If required by Chapter 230 of the Montgomery Township Code (section 230-149b), provide a landscaping plan.
- For aboveground pools, provide a copy of the sales brochure of the pool and any accessories for the pool including prefab decks, ladders, door alarms etc.

Inspections:

- In-ground pools: Footing (vinyl pools only), steel reinforcement, electrical bonding, grid bonding for surrounding concrete pads, final electrical and final pool.
- All other pools: Rough and final electrical, and pool final.
- All pools must show proof of an electrical underwriter's approval prior to scheduling inspections with the township.

APPENDIX G

SWIMMING POOLS, SPAS AND HOT TUBS

(The provisions contained in this appendix are not mandatory unless specifically referenced in the adopting ordinance.)

SECTION AG101 GENERAL

AG101.1 General. The provisions of this appendix shall control the design and construction of swimming pools, spas and hot tubs installed in or on the *lot* of a one- or two-family dwelling.

AG101.2 Pools in flood hazard areas. Pools that are located in flood hazard areas established by Table R301.2(1), including above-ground pools, on-ground pools and in-ground pools that involve placement of fill, shall comply with Sections AG101.2.1 or AG101.2.2.

Exception: Pools located in riverine flood hazard areas which are outside of designated floodways.

AG101.2.1 Pools located in designated floodways. Where pools are located in designated floodways, documentation shall be submitted to the *building official*, which demonstrates that the construction of the pool will not increase the design flood elevation at any point within the *jurisdiction*.

AG101.2.2 Pools located where floodways have not been designated. Where pools are located where design flood elevations are specified but floodways have not been designated, the applicant shall provide a floodway analysis that demonstrates that the proposed pool will not increase the design flood elevation more than 1 foot (305 mm) at any point within the *jurisdiction*.

SECTION AG102 DEFINITIONS

AG102.1 General. For the purposes of these requirements, the terms used shall be defined as follows and as set forth in Chapter 2.

ABOVE-GROUND/ON-GROUND POOL. See "Swimming pool."

BARRIER. A fence, wall, building wall or combination thereof which completely surrounds the swimming pool and obstructs access to the swimming pool.

HOT TUB. See "Swimming pool."

IN-GROUND POOL. See "Swimming pool."

RESIDENTIAL. That which is situated on the premises of a detached one- or two-family dwelling or a one-family *townhouse* not more than three stories in height.

SPA, NONPORTABLE. See "Swimming pool."

SPA, PORTABLE. A nonpermanent structure intended for recreational bathing, in which all controls, water-heating and water-circulating *equipment* are an integral part of the product.

SWIMMING POOL. Any structure intended for swimming or recreational bathing that contains water over 24 inches (610

mm) deep. This includes in-ground, above-ground and on-ground swimming pools, hot tubs and spas.

SWIMMING POOL, INDOOR. A swimming pool which is totally contained within a structure and surrounded on all four sides by the walls of the enclosing structure.

SWIMMING POOL, OUTDOOR. Any swimming pool which is not an indoor pool.

SECTION AG103 SWIMMING POOLS

AG103.1 In-ground pools. In-ground pools shall be designed and constructed in conformance with ANSI/NSPI-5 as listed in Section AG108.

AG103.2 Above-ground and on-ground pools. Above-ground and on-ground pools shall be designed and constructed in conformance with ANSI/NSPI-4 as listed in Section AG108.

AG103.3 Pools in flood hazard areas. In flood hazard areas established by Table R301.2(1), pools in coastal high hazard areas shall be designed and constructed in conformance with ASCE 24.

SECTION AG104 SPAS AND HOT TUBS

AG104.1 Permanently installed spas and hot tubs. Permanently installed spas and hot tubs shall be designed and constructed in conformance with ANSI/NSPI-3 as listed in Section AG108.

AG104.2 Portable spas and hot tubs. Portable spas and hot tubs shall be designed and constructed in conformance with ANSI/NSPI-6 as listed in Section AG108.

SECTION AG105 BARRIER REQUIREMENTS

AG105.1 Application. The provisions of this chapter shall control the design of barriers for residential swimming pools, spas and hot tubs. These design controls are intended to provide protection against potential drownings and near-drownings by restricting access to swimming pools, spas and hot tubs.

AG105.2 Outdoor swimming pool. An outdoor swimming pool, including an in-ground, above-ground or on-ground pool, hot tub or spa shall be surrounded by a barrier which shall comply with the following:

1. The top of the barrier shall be at least 48 inches (1219 mm) above *grade* measured on the side of the barrier which faces away from the swimming pool. The maximum vertical clearance between grade and the bottom of

- the barrier shall be 2 inches (51 mm) measured on the side of the barrier which faces away from the swimming pool. Where the top of the pool structure is above grade, such as an above-ground pool, the barrier may be at ground level, such as the pool structure, or mounted on top of the pool structure. Where the barrier is mounted on top of the pool structure, the maximum vertical clearance between the top of the pool structure and the bottom of the barrier shall be 4 inches (102 mm).
2. Openings in the barrier shall not allow passage of a 4-inch-diameter (102 mm) sphere.
 3. Solid barriers which do not have openings, such as a masonry or stone wall, shall not contain indentations or protrusions except for normal construction tolerances and tooled masonry joints.
 4. Where the barrier is composed of horizontal and vertical members and the distance between the tops of the horizontal members is less than 45 inches (1143 mm), the horizontal members shall be located on the swimming pool side of the fence. Spacing between vertical members shall not exceed 1³/₄ inches (44 mm) in width. Where there are decorative cutouts within vertical members, spacing within the cutouts shall not exceed 1³/₄ inches (44 mm) in width.
 5. Where the barrier is composed of horizontal and vertical members and the distance between the tops of the horizontal members is 45 inches (1143 mm) or more, spacing between vertical members shall not exceed 4 inches (102 mm). Where there are decorative cutouts within vertical members, spacing within the cutouts shall not exceed 1³/₄ inches (44 mm) in width.
 6. Maximum mesh size for chain link fences shall be a 2¹/₄-inch (57 mm) square unless the fence has slats fastened at the top or the bottom which reduce the openings to not more than 1³/₄ inches (44 mm).
 7. Where the barrier is composed of diagonal members, such as a lattice fence, the maximum opening formed by the diagonal members shall not be more than 1³/₄ inches (44 mm).
 8. Access gates shall comply with the requirements of Section AG105.2, Items 1 through 7, and shall be equipped to accommodate a locking device. Pedestrian access gates shall open outward away from the pool and shall be self-closing and have a self-latching device. Gates other than pedestrian access gates shall have a self-latching device. Where the release mechanism of the self-latching device is located less than 54 inches (1372 mm) from the bottom of the gate, the release mechanism and openings shall comply with the following:
 - 8.1. The release mechanism shall be located on the pool side of the gate at least 3 inches (76 mm) below the top of the gate; and
 - 8.2. The gate and barrier shall have no opening larger than 1/2 inch (12.7 mm) within 18 inches (457 mm) of the release mechanism.
 9. Where a wall of a *dwelling* serves as part of the barrier, one of the following conditions shall be met:
 - 9.1. The pool shall be equipped with a powered safety cover in compliance with ASTM F 1346; or
 - 9.2. Doors with direct access to the pool through that wall shall be equipped with an alarm which produces an audible warning when the door and/or its screen, if present, are opened. The alarm shall be listed and *labeled* in accordance with UL 2017. The deactivation switch(es) shall be located at least 54 inches (1372 mm) above the threshold of the door; or
 - 9.3. Other means of protection, such as self-closing doors with self-latching devices, which are *approved* by the governing body, shall be acceptable as long as the degree of protection afforded is not less than the protection afforded by Item 9.1 or 9.2 described above.
 10. Where an above-ground pool structure is used as a barrier or where the barrier is mounted on top of the pool structure, and the means of access is a ladder or steps:
 - 10.1. The ladder or steps shall be capable of being secured, locked or removed to prevent access; or
 - 10.2. The ladder or steps shall be surrounded by a barrier which meets the requirements of Section AG105.2, Items 1 through 9. When the ladder or steps are secured, locked or removed, any opening created shall not allow the passage of a 4-inch-diameter (102 mm) sphere.
- AG105.3 Indoor swimming pool.** Walls surrounding an indoor swimming pool shall comply with Section AG105.2, Item 9.
- AG105.4 Prohibited locations.** Barriers shall be located to prohibit permanent structures, *equipment* or similar objects from being used to climb them.
- AG105.5 Barrier exceptions.** Spas or hot tubs with a safety cover which complies with ASTM F 1346, as listed in Section AG107, shall be exempt from the provisions of this appendix.

SECTION AG106 ENTRAPMENT PROTECTION FOR SWIMMING POOL AND SPA SUCTION OUTLETS

AG106.1 General. Suction outlets shall be designed and installed in accordance with ANSI/APSP-7.

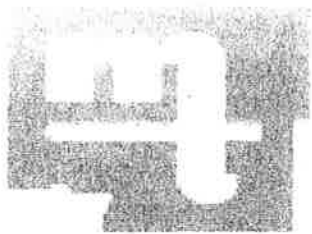

**MONTGOMERY TOWNSHIP
DEPARTMENT OF PLANNING AND ZONING**

1001 STUMP ROAD, MONTGOMERYVILLE, PA 18936-9605
Telephone: 215-393-6920 · Fax: 215-855-1498
www.montgomerytwp.org

Montgomery Township Electrical Inspection Policy

Montgomery Township does not provide in-house electrical inspection services. These services must be obtained by the applicant from one of the authorized electrical inspection agencies listed below. Rough and final electrical inspections must be obtained by the applicant and proof thereof provided. The applicant is responsible for fees required by the selected agency for the services provided.

The rough electrical inspection must be obtained and passed prior to scheduling the Township rough framing inspection. The final electrical inspection must be obtained and passed prior to scheduling the final U&O inspection with the Township. At each of these inspections, the electrical inspection agency must provide an electrical inspection sticker on or near the main distribution panel and must attach an electrical inspection “cut card” for the inspector to remove and retain for Township record.

List of Authorized Electrical Inspection Agencies

**Bureau Veritas North America
(formerly Atlantic Inland Inspections)
790 Parkway Drive
Broomall, PA 19008
610-543-3925**

**Middle Atlantic Electrical Inspections, Inc.
302 E. Pennsylvania Avenue
Feasterville, PA 19053
215-322-2626**

**United Inspection Agency
180 S. Main Street
Ambler, PA 19002
215-542-9977
267-228-5186**

**Code Inspections, Inc.
605 Horsham Road
Horsham, PA 19044
215-672-9400**

**Middle Dept. Inspection Agency
1542 Bristol Pike
Bensalem, PA 19020
215-244-1927
800-992-6342**

**Municipal Inspection Corp
248 Geiger Rd
Philadelphia, PA 19115-1013
(215) 673-4434**

1/21/11

0507, jv

